

# THE CITY OF NAPOLEON

## BUILDING & ZONING DEPARTMENT

255 W. RIVERVIEW

(419)592-4010

---

### Building Permit

Permit Number: BP2006-73

Page 1 of 1

Printed: 7/17/2006

---

### ADDRESS:

**931 Daggett Dr**

### Applicant

Approval Date: 7/17/2006

Name: Bedford Miller

Address: 931 Daggett Dr.

Napoleon, OH 43545

Phone: 419-599-1440

---

### Owners

Name: Mr. Bedford Miller

Phone: 419-599-1440

Address: 931 Daggett Dr.

Napoleon, OH 43545

---

### Contractors

#### Fees and Receipts:

Number	Description	Amount
FEE2006-324	Shed	\$5.00
<b>Total Fees:</b>		<b>\$5.00</b>
RCPT2006-150		\$5.00
<b>Total Receipts:</b>		<b>\$5.00</b>

---

0

0

shed

APPLICANTS SIGNATURE:

*Bedford Miller*

DATE

*7-17-06*

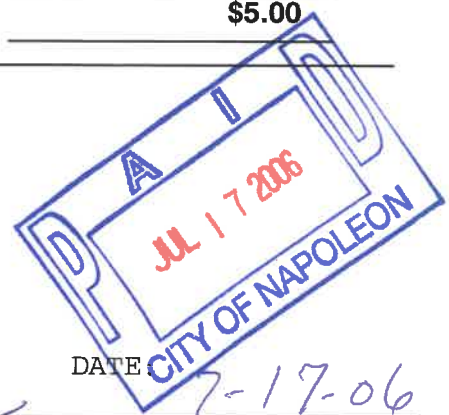



# CITY OF NAPOLEON GENERAL PERMIT APPLICATION

THIS APPLICATION IS FOR RESIDENTAL CONSTRUCTION INCLUDING BUILDING, ELECTRICAL, PLUMBING, MECHANICAL, DEMOLITIONS, REMODELING.

DATE: 7-17-06 JOB LOCATION: 931 Daggett ave

OWNER: Bedford Miller PHONE: 419-599-1440

OWNER ADDRESS: 931 Daggett ave CITY: Napoleon ZIP: 43545

CONTRACTOR: self

PHONE #: \_\_\_\_\_ CELL PHONE# 996-2415

CONTRACTOR LICENSED WITH THE CITY OF NAPOLEON?: YES  NO:

Is any of the above job going to be subcontracted out? Yes  No:

If yes to whom: \_\_\_\_\_

DESCRIPTION OF WORK TO BE PERFORMED: \_\_\_\_\_

ESTIMATED COMPLETION DATE: \_\_\_\_\_

## PLEASE MARK THE TYPE OF WORK YOU WILL BE PERFORMING

- |   |  |
|---|--|
| <input type="checkbox"/> A/C ADD ON                 | <input type="checkbox"/> REMODELING              |
| <input type="checkbox"/> BOILER REPLACEMENT         | <input type="checkbox"/> ROOFING                 |
| <input type="checkbox"/> CURBING                    | <input type="checkbox"/> SEWER REPAIRS**         |
| <input type="checkbox"/> DECKS *                    | <input type="checkbox"/> SIDEWALK*               |
| <input type="checkbox"/> DRIVEWAY*                  | <input type="checkbox"/> SIDING                  |
| <input type="checkbox"/> ELECTRICAL SERVICE UPGRADE | <input type="checkbox"/> STORAGE SHED*           |
| <input type="checkbox"/> ELECTRICAL SERVICE NEW     | <input type="checkbox"/> SWIMMING POOL*          |
| <input type="checkbox"/> FENCE*                     | <input type="checkbox"/> FURNACE REPLACEMENT     |
| <input type="checkbox"/> ADDITIONS*                 | <input type="checkbox"/> TEMP ELECTRIC           |
| <input type="checkbox"/> FURNACE NEW                | <input type="checkbox"/> WATER TAP (size _____") |
| <input type="checkbox"/> LAWN METER                 | <input type="checkbox"/> WINDOWS                 |
| <input type="checkbox"/> PLUMBING                   | <input type="checkbox"/> ZONING                  |

\*PLEASE INCLUDE A PICTURE SHOWING MEASUREMENTS FROM EXISTING STRUCTURES AND PROPERTY LINES. INDICATING THE TYPE OF WORK YOU WISH TO PERFORM.

\*\* IF WORK REQUIRES GOING INTO THE STREET A STREET BOND IS REQUIRED!

FOR PERMIT COSTS PLEASE FILL OUT REVERSE SIDE.

## PERMIT COST WORKSHEET

JOB	BASE FEE	TOTAL
SIDING (only) TOTAL SQ _____ X 1.00 +	\$5.00 =	\$ _____
ROOFING (only) TOTAL SQ _____ X 1.00 +	\$5.00 =	\$ _____
WINDOWS (only) # OF WINDOWS ____ X 1.00 +	\$5.00 =	\$ _____
ELECTRICAL # OF CIRCUITS ____ X 3.00 +	\$15.00 =	\$ _____
ELECTRICAL SERVICE UPGRADE	\$15.00 =	\$ _____
PLUMBING (INSIDE) replacing/ repairs	\$10.00 =	\$ _____
SEWER (OUTSIDE)	\$25.00 =	\$ _____
WATER HEATER	\$5.00	\$ _____
SHED UNDER 200 SQ FT (over 200 see chart)	\$ 5.00	\$ <u>5.00</u>
FURNACE OR A/C (REPLACEMNT)	\$ 5.00	\$ _____
DEMOLITION (only)	\$30.00	\$ _____
SIDEWALK REPLACEMENT/ NEW	\$25.00	\$ _____
DRIVEWAY	\$25.00	\$ _____

\* Additional Fees MAY APPLY

ALL CONSTRUCTION, ALTERATIONS, REMODELING, SHEDS, DECKS & FENCES NOT LISTED ABOVE IS BASED ON COST OF WORK BEING PERFORMED.

COST OF WORK \$ \_\_\_\_\_ (SEE CHART) \$ \_\_\_\_\_

0.00	-	250.00	0.00	11,000.00	-	11,999.00	25.00
250.00	-	1,000.00	10.00	12,000.00	-	12,999.00	26.00
1,000.00	-	1,999.00	12.00	13,000.00	-	13,999.00	27.00
2,000.00	-	2,999.00	14.00	14,000.00	-	14,999.00	28.00
3,000.00	-	3,999.00	16.00	15,000.00	-	15,999.00	29.00
4,000.00	-	4,999.00	18.00	16,000.00	-	16,999.00	30.00
5,000.00	-	5,999.00	19.00	17,000.00	-	17,999.00	31.00
6,000.00	-	6,999.00	20.00	18,000.00	-	18,999.00	32.00
7,000.00	-	7,999.00	21.00	19,000.00	-	19,999.00	33.00
8,000.00	-	8,999.00	22.00	20,000.00	-	20,999.00	34.00
9,000.00	-	9,999.00	23.00	21,000.00	-	21,999.00	35.00
10,000.00	-	10,999.00	24.00	22,000.00	-	22,999.00	36.00
				Over 22,999		Please Call	

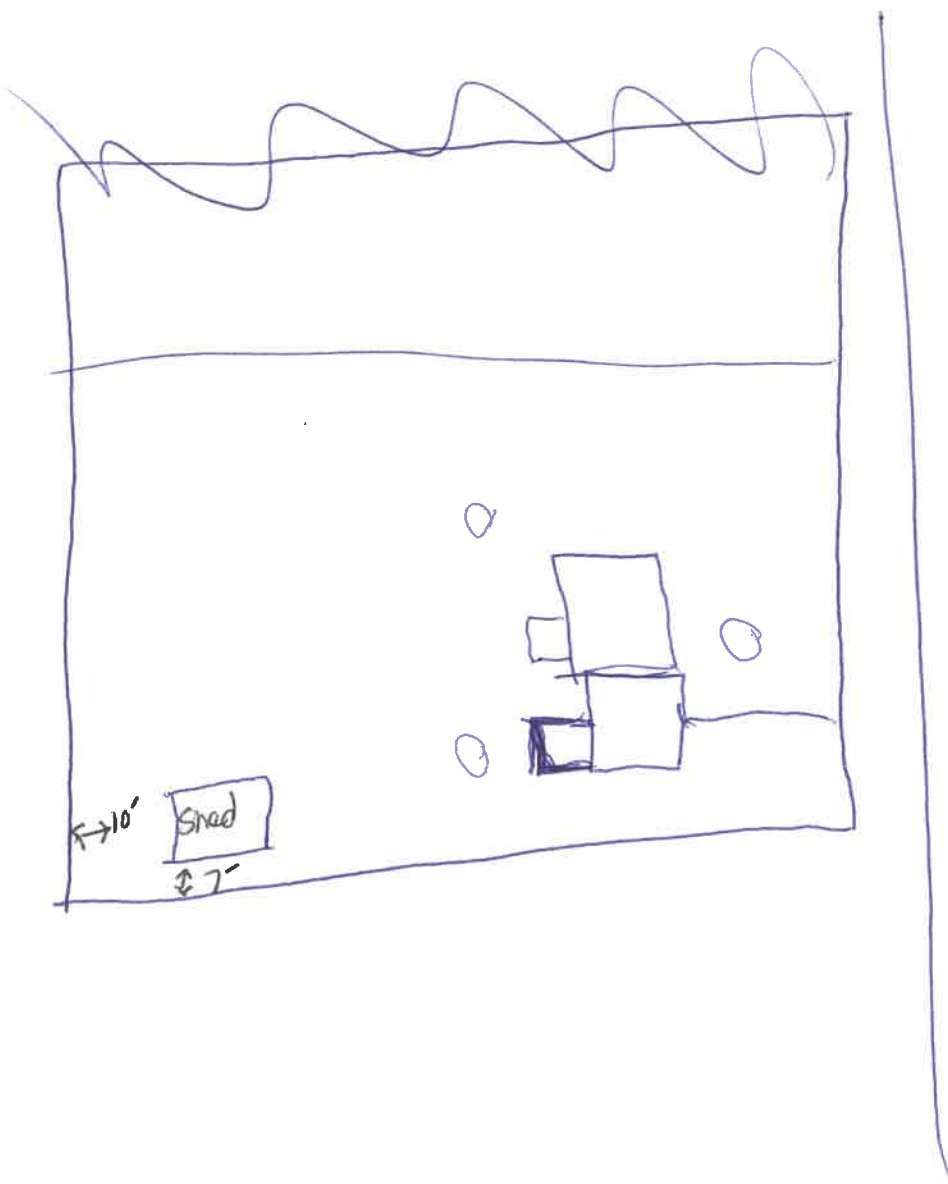

EAST MAUMEE

